

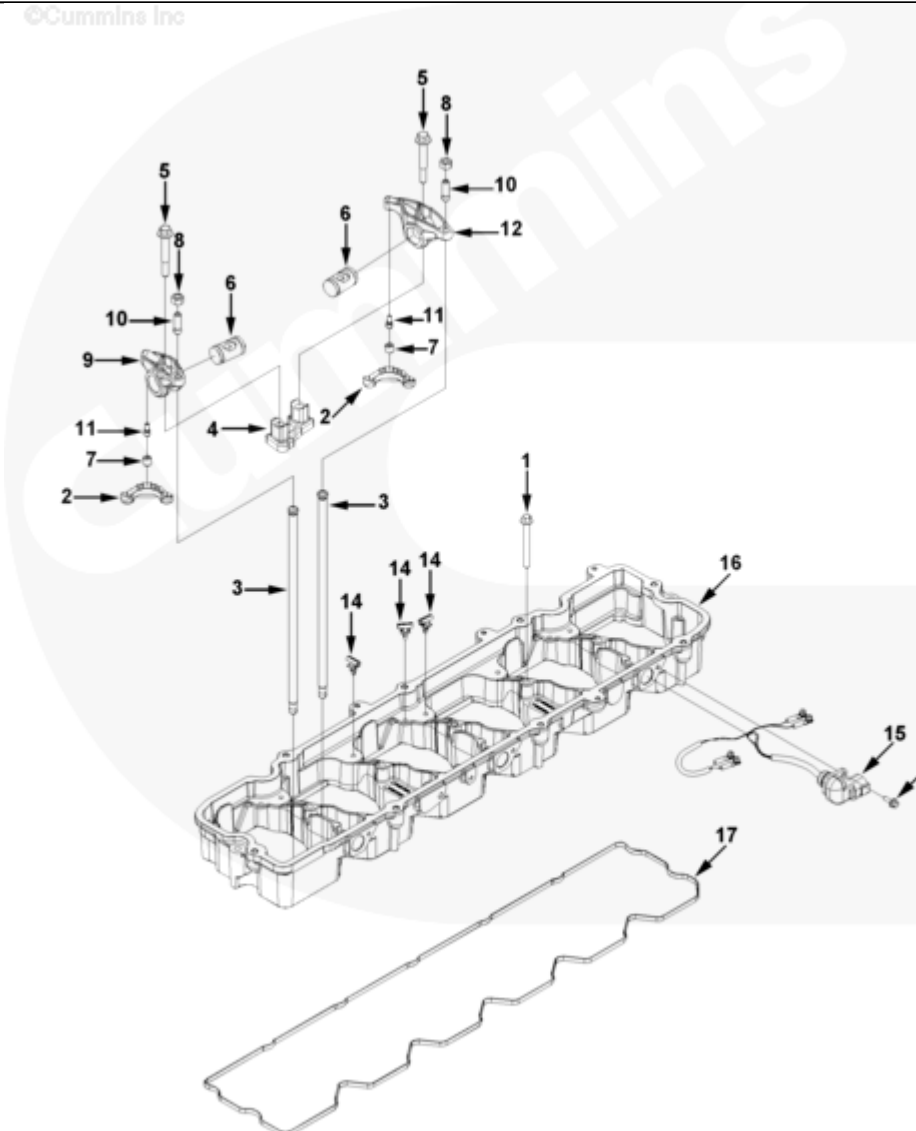

# Parts Catalog - Option Detail

Electronic Parts Catalog - Option Detail				
Option	Group	Graphic	Film Card	Date
RL9753-06	03.01	r1942gz	Z	09-APR-12
<b>Engines</b>	6C8.3, C GAS PLUS CM556, G8.3, G8.3 CM558, GTA8.3 CM558, ISC CM2150, ISC CM554, ISC CM850, ISC8.3 CM2250, ISC8.3 G CM2180 C101, ISL CM2150, ISL CM554, ISL CM850, ISL G CM2180, ISL8.9 CM2150 L110, ISL8.9 CM2880 L112, ISL9 CM2150 SN, ISL9 CM2250, ISL9 CM2350 L101, ISL9 CM2350 L111, ISLE4 CM850, L GAS PLUS CM556, L8.9, L8.9 L121, L8.9G CMOH2.0 L125B, L9 CM2350 L116B, L9 CM2350 L119B, L9 CM2350 L120C, L9 CM2350 L123B, L9.3 L105, L9.5 L117, L9N CM2380 L124B, QSC8.3 CM2250, QSC8.3 CM2880 C102, QSC8.3 CM554, QSC8.3 CM850(CM2850), QSL9 CM2250, QSL9 CM2250 L115, QSL9 CM2350 L102, QSL9 CM2350 L107, QSL9 CM2350 L118, QSL9 CM2350 L122, QSL9 CM554, QSL9 CM850(CM2850), QSL9 G CM558, QSL9 M CM2250 L106, QSL9.3 CM2880 L113			



r1942gz

Cart	Ref No	Part Number	Part Description	Required	Remarks
<input type="button" value="View My Cart"/>					
		<a href="#">RL9753-06</a>	Rocker Lever		<a href="#">LEVER, ROCKER...(More)</a>
					Engine Brake Compatible: No
					High Pressure Common Rail
					(HPCR) Capable: Yes
					Fuel Pump Manufacturer/Model:
					Cummins/CAPS2
<input type="checkbox"/>	1	<a href="#">3901447</a>	Hexagon Flange Head Cap Screw	7	M8 X 1.25 X 75.
<input type="checkbox"/>	2	<a href="#">3943445</a>	Valve Crosshead	12	
<input type="checkbox"/>	3	<a href="#">3964715</a>	Push Rod	12	
<input type="checkbox"/>		<a href="#">5253887</a>	Rocker Lever Assembly	6	
<input type="checkbox"/>	4	<a href="#">3941140</a>	Rocker Lever Support	1	
<input type="checkbox"/>	5	<a href="#">3943933</a>	Hexagon Flange Head Cap Screw	2	M10 X 1.50 X 68.
<input type="checkbox"/>	6	<a href="#">3966658</a>	Rocker Lever Shaft	2	
<input type="checkbox"/>		<a href="#">4995630</a>	Rocker Lever	1	Intake.
	7	<a href="#">4994198</a>	Rocker Lever Socket	1	
<input type="checkbox"/>		<a href="#">4995633</a>	Rocker Lever	1	Intake.
<input type="checkbox"/>	8	<a href="#">203131</a>	Heavy Hexagon Nut	1	3/8 - 24 UNF.
	9	<a href="#">3941934</a>	Rocker Lever	1	
<input type="checkbox"/>	10	<a href="#">3964720</a>	Rocker Lever Adjusting Screw	1	
	11	<a href="#">4994197</a>	Rocker Lever Ball	1	
<input type="checkbox"/>		<a href="#">5253888</a>	Rocker Lever	1	Exhaust.
	7	<a href="#">4994198</a>	Rocker Lever Socket	1	
<input type="checkbox"/>		<a href="#">5253889</a>	Rocker Lever	1	Exhaust.
<input type="checkbox"/>	8	<a href="#">203131</a>	Heavy Hexagon Nut	1	3/8 - 24 UNF.
<input type="checkbox"/>	10	<a href="#">3964720</a>	Rocker Lever Adjusting Screw	1	
	11	<a href="#">4994197</a>	Rocker Lever Ball	1	
	12	<a href="#">3941937</a>	Rocker Lever	1	
<input type="checkbox"/>		<a href="#">5295879</a>	Rocker Lever Housing	1	

<input type="checkbox"/>	13	<a href="#">3913638</a>	Hexagon Flange Head Cap Screw	3	M6 X 1.00 X 16.
<input type="checkbox"/>	14	<a href="#">3963736</a>	Wire Retaining Clip	8	
<input type="checkbox"/>	15	<a href="#">3968886</a>	Wiring Harness	3	
<input type="checkbox"/>	16	<a href="#">5254268</a>	Rocker Lever Housing	1	
<input type="checkbox"/>	17	<a href="#">5272959</a>	Rocker Lever Housing Gasket	1	
<input type="checkbox"/>		<a href="#">3931824</a>	O-Ring Seal	3	

© 2019 Cummins Inc., Box 3005, Columbus, IN 47202-3005 U.S.A.  
Terms of Use and Disclaimers | Recommended System Requirements  
Need Assistance? Please click on the Contact Us button in the top right corner of any page.